

## **TRAFFIC CONTROL IMPLEMENTATION**

At the 2019 annual homeowners meeting, those present requested that the Board of Directors look into means to control the speed by vehicles on River Oaks Drive. The board at its next regular meeting in April 2019 the Board approved that the Capital committee look into Traffic control alternatives of STOP signs, Speed Humps and Radar Speed indicating devices. At the July 2019 meeting the Board sanctioned a Traffic Control study by a Traffic Engineering firm. This was done as a result of a recommendation from the St Tammany Sheriff's Office (STPSO) and St Tammany Parish Department of Public Works.

St Tammany Sheriff's Office provided Radar Speed Data from two locations – inbound and outbound to the Association. The Association contracted with JV Burkes Engineering to give us recommendations on Traffic Speed Control Alternatives. They used the STPSO data and their knowledge of best practices in speed control to develop recommendation for River Oaks. At the October 2019 the Board approved the implementation of the recommendations of the consultant, JV Burkes. The project will be funded from the "Reserve for Capital Projects" account.

The recommendations to be implemented:

1. Request the St Tammany Parish Government to pass an ordinance authorizing the STPSO to issue traffic citations and monitor the roadways of the subdivision.
2. Install 3-Way STOP signs at Hardy and River Oaks.
3. Install 4 additional Speed Limit signs to accommodate a rotating radar speed detection sign with feedback to driver.
4. Purchase a radar speed feedback sign and software system associated with the radar sign to document time and level of speeding.
5. Install rotating radar speed sign on a rotating basis on Speed Limit signs. The outgoing signs will be rotated on Hardy, River Oaks and Greenluster, River Oaks and Vesper and River Oaks and Winterberry. The incoming signs will also be rotated on Hardy, River Oaks and Greenluster, River Oaks and Vesper and River Oaks and Winterberry.

Attached are the following documents:

1. Resolution submitted on 10.30.19 to the St Tammany Parish Government that the St. Tammany Parish Sheriff's Department be and is hereby authorized to perform police details and issue traffic citations within the Community to control traffic violation in accordance with the law of St Tammany Parish and the State of Louisiana
2. STPSO radar study
3. JV Burkes recommendation on STOP signs and review of STPSO data
4. JV Burkes additional recommendations on additional speed and safety controls
5. Map of locations of STOP and Speed Limit signs
6. Data sheet on Radar Feedback sign

**RESOLUTION OF THE BOARD OF DIRECTORS OF**  
**MANDEVILLE RIVER OAKS OWNERS ASSOCIATION, INC.**

ASSOCIATION, INC. (the "Association"), does hereby adopt the following Resolution:

WHEREAS, pursuant to

ARTICLE III, SECTION 1 AND 2 for MANDEVILLE RIVER OAKS OWNERS Subdivision (the "Community..") (the "Covenants"), St. Tammany Parish has a perpetual, non-exclusive right and easement upon, over and across all of the property subject to the Covenants for purposes of performing any and all duties and activities related to emergency, security and other public safety concerns in the Community as shall be required or appropriate from time to time by such governmental authority under applicable law.

WHEREAS, the Association agrees to maintain the roadways within the Community and to place and maintain all stop signs, posted speed limit signs and other traffic signs within the Community in accordance with all standards as may be mandated by the Louisiana Department of Transportation and Development. The Association further agrees to hold harmless and indemnify St. Tammany Parish and the St. Tammany Parish Sheriff's Department from any and all damages that may occur from the placement and maintenance of any such signs, and from authorizing the St. Tammany Parish Sheriff's Department to enforce the stop signs, posted speed limit signs and other traffic controls within the Community.

NOW THEREFORE, BE IT RESOLVED by the Board of Directors for the MANDEVILLE RIVER OAKS OWNERS ASSOCIATION, INC., that pursuant to Article XV of the Covenants, St. Tammany Parish be and is hereby granted jurisdiction over all of the property subject to the Covenants with respect to lawenforcement.

NOW THEREFORE, BE IT FURTHER RESOLVED by the Board of Directors for the MANDEVILLE RIVER OAKS OWNERS ASSOCIATION, INC., that the St. Tammany Parish Sheriff's Department be and is hereby authorized to perform police details and issue traffic citations within the Community to control traffic violation in accordance with the law of St Tammany Parish and the State of Louisiana.

DONE AND SIGNED this 30<sup>th</sup> day of October, 2019.



R. J. ROWALT, PRESIDENT  
MANDEVILLE RIVER OAKS OWNERS ASSOCIATION, INC.



SHANNON OBER, SECRETARY  
MANDEVILLE RIVER OAKS OWNERS ASSOCIATION, INC.



**St. Tammany Parish Sheriff's Office**

**Traffic Division**

300 Brownswitch Road

Slidell, LA 70458

(985) 726-7810

Site Code: 00000001

Station ID:

River Oaks Drive

Latitude: 0' 0.0000 South

Direction 1													
1-5	6-10	11-15	16-20	21-25	26-30	31-35	36-40	41-45	46-50	51-55	56-60	61-65	>65
0	9	49	200	1427	1799	273	14	0	4	0	0	0	0

85 percentile = 28

Direction 2

Direction 2														
	1-5	6-10	11-15	16-20	21-25	26-30	31-35	36-40	41-45	46-50	51-55	56-60	61-65	>65
	0	5	107	543	1993	788	32	0	0	0	0	0	0	0
85 percentile = 25														

Combined

Combined	6-10	11-15	16-20	21-25	26-30	31-35	36-40	41-45	46-50	51-55	56-60	61-65	>65
1-5		156	743	3420	2587	305	14	0	4	0	0	0	0
0	14	156	743	3420	2587	305	14	0	4	0	0	0	0

85 percentile = 27

Page 1

**St. Tammany Parish Sheriff's Office**

Traffic Division

300 Brownswitch Road

Slidell, LA 70458

Site Code: 00000001

Station ID:

Latitude: 0° 0.0000 South

	1-5	6-10	11-15	16-20	21-25	26-30	31-35	36-40	41-45	46-50	51-55	56-60	61-65	>65
Lane1	1-5	6-10	11-15	16-20	21-25	26-30	31-35	36-40	41-45	46-50	51-55	56-60	61-65	>65
	2	2	98	269	748	613	96	14	1	0	1	0	0	2

85 percentile = 27

Lane2

Lane2													
1-5	6-10	11-15	16-20	21-25	26-30	31-35	36-40	41-45	46-50	51-55	56-60	61-65	>65
0	10	93	350	735	263	25	3	1	0	0	0	0	0

85 percentile = 25

Combined

	1-5	6-10	11-15	16-20	21-25	26-30	31-35	36-40	41-45	46-50	51-55	56-60	61-65	>65
Combined														
	1-5	6-10	11-15	16-20	21-25	26-30	31-35	36-40	41-45	46-50	51-55	56-60	61-65	>65
	2	12	191	619	1483	876	121	17	2	0	1	0	0	2

85 percentile = 27

St. Tammany Parish Sheriff's Office  
Traffic Division

300 Brownswitch Road  
Slidell, LA 70458  
(985) 726-7810

Site Code: 00000001  
Station ID:  
RiverOaks Drive  
Winterberry Drive  
Latitude: 0' 0.0000 South

Volume Sorted By Speed for 13-Jun-19 to 17-Jun-19

Direction: Combined

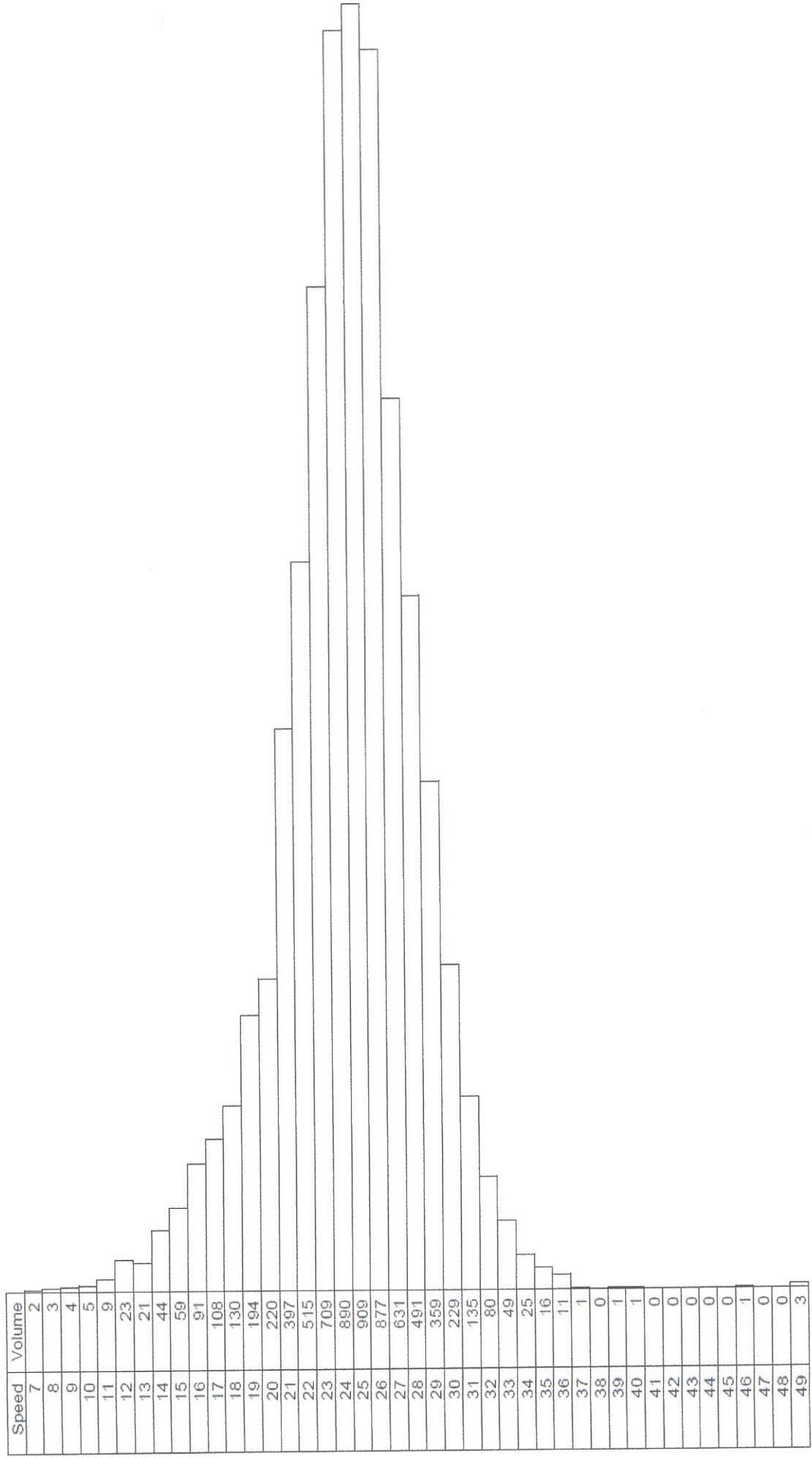

St. Tammany Parish Sheriff's Office
Traffic Division
300 Brownswitch Road
Slidell, LA 70458
(985) 726-7810

Site Code: 00000001
Station ID:
River Oaks Drive
SweetBay
Latitude: 0' 0.0000 South

Volume Sorted By Speed for 01-Jul-19 to 05-Jul-19

Direction: Combined

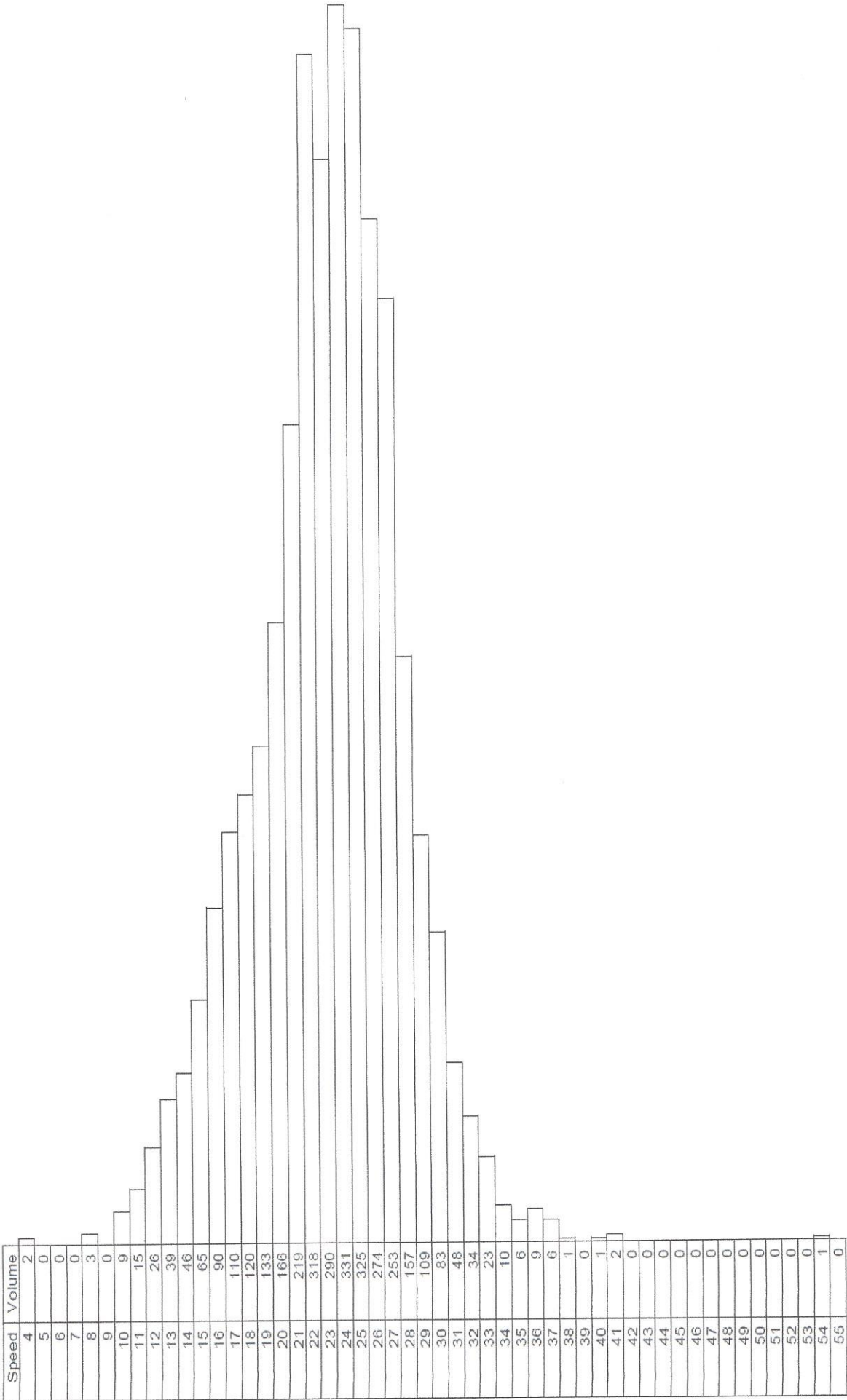



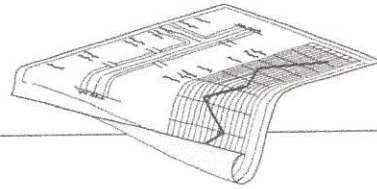

August 2, 2019

Mr. Bennie Daigle  
River Oaks Estates Board of Directors  
202 Turnberry Dr  
Covington, LA 70433

**RE: River Oaks Drive Speed and Stop Sign Review  
South of Covington, St. Tammany Parish, Louisiana**

Dear Mr. Daigle

As you requested, I have reviewed the River Oaks Drive information you provided detailing results of the recent speed studies performed by St. Tammany Parish Sherriff's Office, and map showing potential locations for placement of additional "Stop" signs.

Regarding the proper speed limit to post along Rive Oaks Drive, it is standard practice by most governing agencies and Traffic and Transportation Engineers to post the speed limit at or just below what is called the "85<sup>th</sup> percentile speed". This is the speed that a study determined 85 percent of drivers were traveling at or below during the study. It is considered the best method to determine the appropriate speed to post a roadway. Speed limits set higher than the 85<sup>th</sup> percentile speeds are considered unsafe, while speed limits set lower can have high levels of non-compliance and become difficult to enforce.

The recent speed studies conducted by St. Tammany Parish Sherriff's Office along River Oaks Drive at two locations, one near Winterberry Drive and the other near Sweet Bay Court, revealed an 85<sup>th</sup> percentile speed of 27 mph at both locations. This indicates the existing posted speed limit of 25 mph along River Oaks Drive is the appropriate speed for this roadway. Hence, no change to the speed limit is recommended.

A review of the map of potential locations for additional Stop signs along River Oaks Drive and our recent field inspections indicate the best potential location is at Hardy Drive. This is midways between a generally straight (slightly curved) section of River Oaks Drive between Carissa Court and Vesper Lane. It will also provide a more evenly spaced system of "Stop" signs with the two existing "Stop" sign locations along the length River Oaks Drive.

This concludes our review and findings at this time. Please let me know if you have any questions or need additional information.

Respectfully,

Johnny Bordelon, P.E., PTOE  
Senior Traffic Engineer, Project Manager  
J.V. Burkes & Associates, Inc.

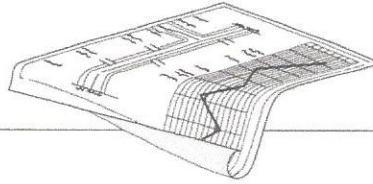

October 17, 2019

Mr. Bennie Daigle  
River Oaks Estates Board of Directors  
202 Turnberry Dr  
Covington, LA 70433

**RE: River Oaks Drive Speed and Stop Sign Review  
South of Covington, St. Tammany Parish, Louisiana**

Dear Mr. Daigle

This is a follow up to my letter to you dated August 2, 2019 providing recommendations for speed limit and stop sign controls along River Oaks Drive. Since that letter we have had discussions with St. Tammany Parish Government and reviewed additional measures to address speed and safety concerns along River Oaks Drive. Based on information received from the Parish and further review of traffic controls along the roadway, I offer the following additional recommendations for your consideration.

- Request the St. Tammany Parish Government pass an ordinance authorizing the St. Tammany Parish Sheriff's Office to issue traffic citations and monitor the roadways within the subdivision.
- Place additional speed limit signs along River Oaks Drive inbound (westbound) in the vicinity of Winter Berry Drive and the vicinity of Greenluster Drive, and River Oaks Drive outbound (eastbound) in the vicinity of Greenluster Drive. A speed limit sign should also be placed along Hardy Drive outbound (eastbound) in the vicinity of Needle Point Lane.
- Purchase one or two Portable Radar Speed Signs that can be moved and placed as needed at various locations to alert motorists of their travel speed. These can be purchased as battery powered or solar powered devices, and with software that can record vehicles speeds for analysis and reporting purposes.
- Based on effectiveness of the above and review of collected speed data from the radar signs, speed bumps may be considered where speeds are still a concern.

No additional "Stop" signs are recommended other than those from our August 2, 2019 letter.

We remain available to consult with you further should you have any questions or need additional information.

Respectfully,

Johnny Bordelon, P.E., PTOE

Senior Traffic Engineer, Project Manager  
J.V. Burkes & Associates, Inc.





River Oaks Estates  
#1 River Oaks Drive  
Covington, LA 70433

**SPEED LIMIT**  
**SPEED LIMIT**  
**SPEED LIMIT**

STREET NAME	LENGTH (FT)
C/L ABELIA	1670
C/L ANDORRA LN.	4177
C/L ARISTOCRAT	2856
C/L BENT TREE	11948
C/L BRADFORD CT.	3476
C/L CARRISA	12169
C/L COPPERMAN	559.3
C/L GREENLUSTER	726.8
C/L HARDY DR.	1578.2
C/L LANTANA CT.	297.4
C/L NEEDLEPOINT LN.	400.0
C/L RIVER OAKS DR. BLVD	1820.3
C/L RIVER OAKS DR. PH. 3	1973.2
C/L RIVER OAKS DR. PH. 5	1138.1
C/L RIVER OAKS TO PH 1	802.9
C/L RUTHERFORD	1208.1
C/L SWEET BAY	400.0
C/L TRADITION	100.0
C/L TURNBERRY	1214.4
C/L VESPER	434.1
C/L WALKING STICK	197.5
C/L WINTERBERRY	683.1
C/L WOODBERRY	1582.9
C/L SMOKETREE	650.0

TOTAL 3.63 Miles

**SPEED LIMIT**  
**IN**  
**MEDIAN**

**FACILITIES LEGEND**

- 1 - CLUBHOUSE
- 2 - POOL
- 3 - TENNIS COURTS

125' CENTRAL LOUISIANA ELECTRIC COMPANY RIGHT-OF-WAY

**STOP**  
**Signs**

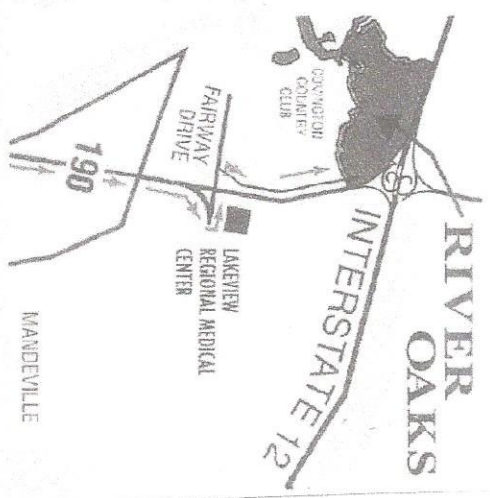
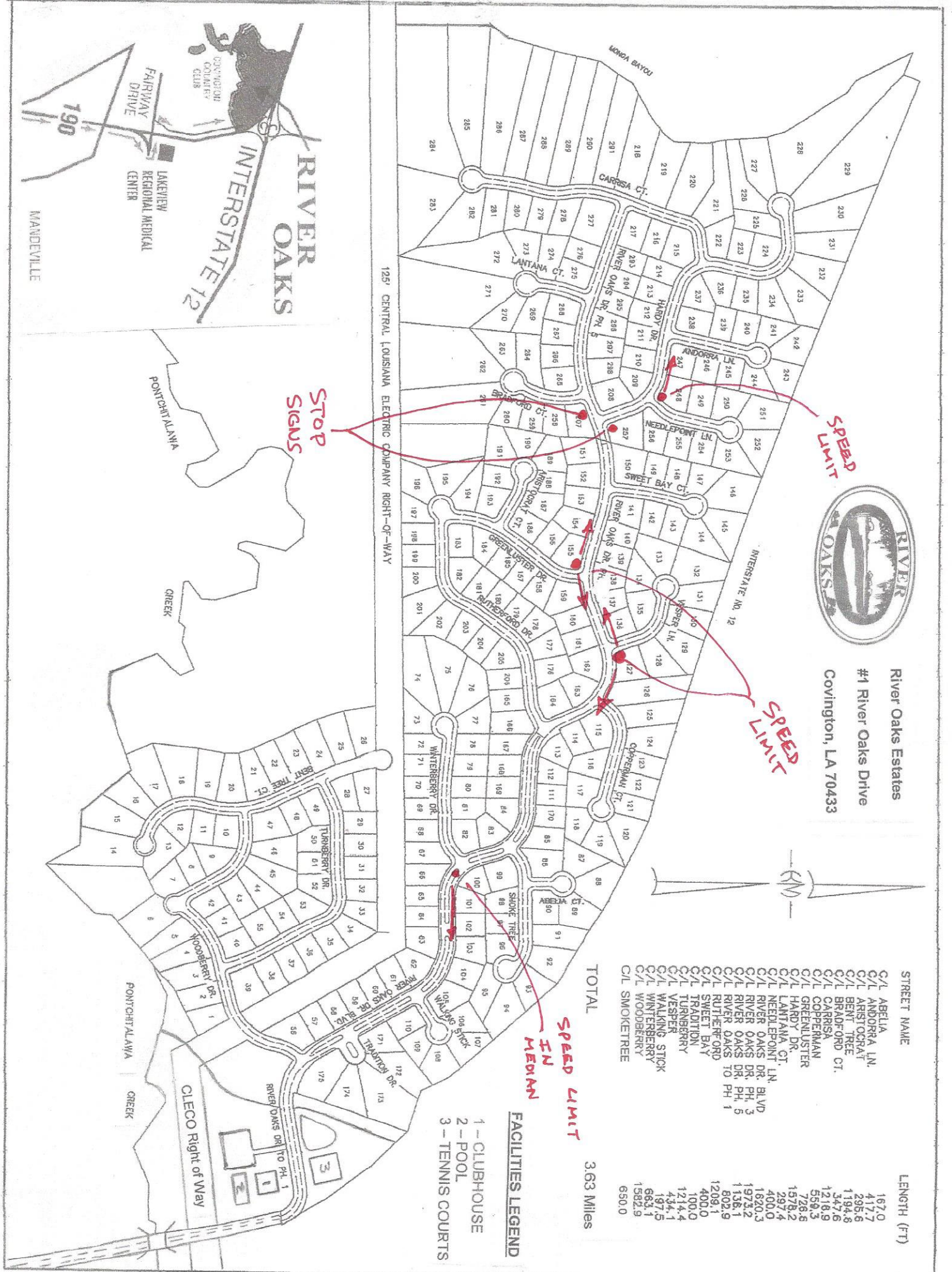



## 12" RADAR SIGNS

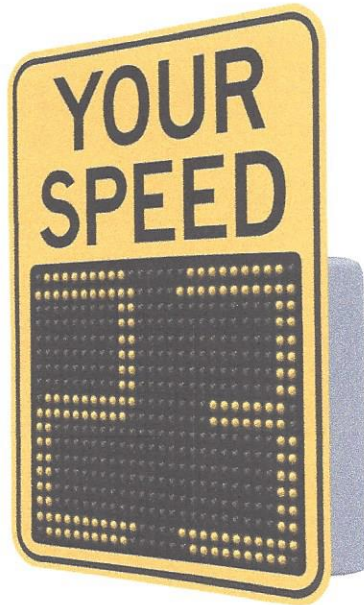

## SAFEPACE EVOLUTION 12FM

### Variable Message Sign

The SafeSpace Evolution 12FM variable message sign is a compact, portable solution offering adjustable driver-responsive messages.

The compact yet robust Traffic Logix SafeSpace Evolution 12FM offers the flexible, customizable messaging options you'd expect from a larger sign. The sign includes a full matrix for text, graphics, or 12" speed display, including speed activated digit color changes and choice of messaging color. The Evolution 12FM sign is the sign with a small footprint yet wide range of messaging options.

### Features:

- 1 Year cloud connectivity included
- Compact sign with smaller 12" digits
- Affordable pricing
- Static Your Speed message
- Allows for animated text or graphics
- Lightweight, compact design
- Energy efficient power options
- Dual-color LED display
- 3 digit display
- Diamond-grade sheeting available
- Strobe activation/deactivation available

<https://trafficlogix.com/safespace-evolution-12fm/>